



Instructions

MiraMate

January · 2020

Simple ● Convenient ● Effective ● Versatile

To Dear Consumer:

Dear friend, thank you for choosing MiraMate. Please read these instructions carefully before using the products, and save this manual for future reference.



Table of Contents

Mini Magic

Introduction	1
Warnings	1
Parcel Contents	2
Power Supply Options	3
Coil Connection	5
Coil Positioning	7

Big Magic

Introduction	10
Warnings	10
Parcel Contents	11
Main Unit Overview	12
Preparing For Use	12
Indicator Lights	16
Tips	17

Flash

Brief Overview	18
New to VUV	20
Parcel Contents	25
Main Structure	26
Operation Instructions	28
Cautions	38
Transportation and Storage	41
Warranty	41
Specifications	43

Joint Aid

Brief Overview	44
Parcel Contents	45
Main Structure	46
Specifications	48
Operation Instructions	49
Trouble-shooting Instructions	54
Maintenance and Preservation	55
Transportation and Storage	56
Warranty	56
Symbol Descriptions	57

Magic

MiraMate

Mini Magic

Introduction

Mini Magic is a new portable PEMF device designed to reduce pain and discomfort anywhere, anytime.

A small blessing to people suffering from acute pain. Discrete, stylish, and easy to use. Mini Magic can be used daily with confidence. If you can flick a switch, you can use Mini Magic. Don't live your life in unnecessary pain. The Mini Magic will become your miracle mate, providing support when you most need it.

Warning

Never use Mini Magic in, near, or around water. Mini Magic's powerful magnetic pulses also prohibit its use under the following circumstances:

During Pregnancy

When using a Non-MRI-Safe IUD

People or Animals with Organ Transplants

People or Animals with Pacemakers, Hearing Aids, Medical

Pumps, or other Electrical Implants/Devices

NOTE

Non-magnetic metal rods, screws, and plates are safe for PEMF use. If an implant is safe for an MRI, it is safe to use Mini Magic.

Parcel Contents

Your parcel contains one wrist band (big) and two boxes: One small and the other one larger:



The small box

contains a 5V power adapter, USB power cable, and wrist band (small).



The larger box

has two layers. On the top is the main unit. Under this is a pair of single coils, velvet bag, and coil tester.



Power Supply Options

There are three options to supply power to Mini Magic: 9v battery, portable power supply, or mains power (using the 5v power adapter). The first two options grant you freedom to move during treatments.

1 . If you choose to use a 9v battery, we suggest you using a lithium battery. The battery compartment is accessed by gently pressing this tab:



- The lid can then be gently lifted off.



- The battery is inserted into the battery compartment as shown in this photo. It is important to have the battery orientated correctly, with the positive terminal on the right-hand side.

3

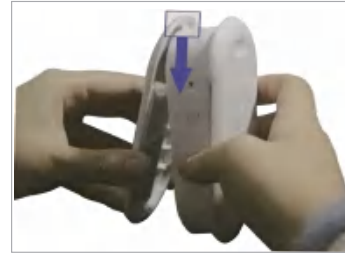

- Position the lid so the top is held by a tab on the main unit, and gently click the lid shut. Do not use excessive force.

2 . The USB Power Cable can be connected to a portable power supply. This provides longer treatment durations.



4

3 . The same USB Power Cable can also be used with the 5V power adapter.



- You can choose the power option that best suits your needs.

Tips: When you use the portable power supply or mains power, please take the battery out. If you leave the battery inside, it will take power from the battery first.

Coil Connection

The next step is to plug the coil into Mini Magic. Make sure the coil plug is fully inserted into the socket.

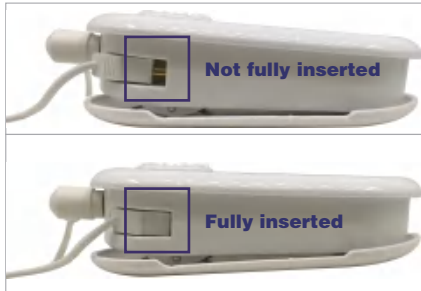

5



- You can set the desired power level using the 3-position rotary switch. Level three is the one we recommend. If you are sensitive, you can select a lower power level.



- Turn on Mini Magic using the switch located on the right.

Coil Placement

There are two sides for the coils; one side is smooth, and the other is bumpy. The coils must always have the smooth side touching your skin.

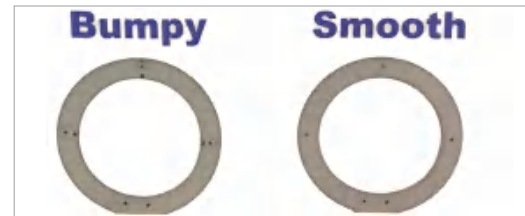

6

Coil Positioning

There are three different options for positioning the coils. Here we show some examples for treating the wrist.



1. Side by side

The first option is to have the coils side by side. This increases the area being treated, but the treatment depth is shallow.



2. Across treatment area

The second option is to have the coils across the treatment area, so the coils face each other. This is our recommended option for most situations. In this way, every part between the coils will be treated.



3. Stacked

The third option is to stack them on top of each other. The bumps of the coils must face each other. This option is similar to placing the coils side by side, but the depth is increased.

Similar coil positioning can be used for other body areas. It is ok to do it over clothing as long as the clothes are not too thick.

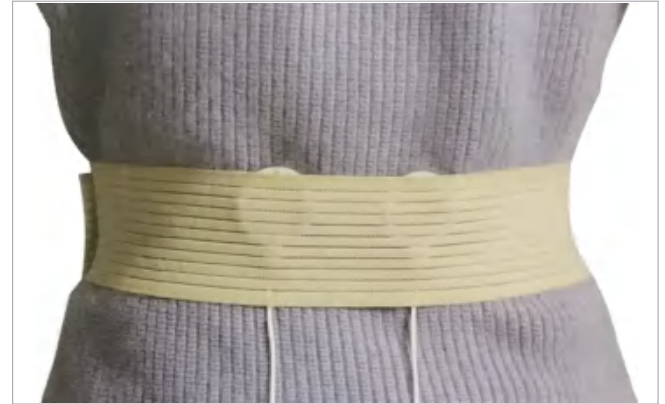



- Please make sure the shirt button does not contain metal.

Coil Testing

The coils make a tiny ticking sound when they are placed on top of each other. This can be difficult to hear, so we provide a Coil Tester. Place the coils individually on top of the Coil Tester. The red lights should flash regularly during operation.



Big Magic

Introduction

Big Magic is called "Magic" for good reason; regular use will produce truly magical results. Chronic health issues can slowly disappear, without disruption to your everyday schedule. Big Magic uses the natural Schuman frequency to induce healing. The mat covers large areas like the spine and legs, for extra convenience.

The power consumption of Big Magic is low. You can set up your wonderful Big Magic, then forget it, knowing your health will improve every night.

Pets also benefit from Big Magic. Place the mat under their sleeping pad, so they too can benefit from the naturally-healing waves.

Warning

Never use Big Magic in, near, or around water. Big Magic's magnetic pulses also prohibit its use under the following circumstances:

During pregnancy.

While using a non-MRI-safe IUD.

People or animals with organ transplants.

People or animals with pacemakers, hearing aids, medical pumps, or other electrical implants/devices.

NOTE

Non-magnetic metal rods, screws, and plates are safe for PEMF use. If an implant is safe for an MRI, it is safe to use Big Magic.

Parcel Contents

Your parcel contains a single, large box.



This box has two layers. The top layer has the main unit, 5V power supply and USB power cable. The lower layer has the PEMF mat and coil tester.

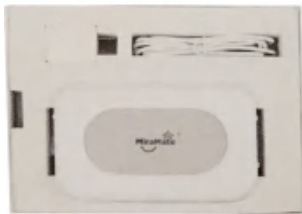

Main Unit Overview

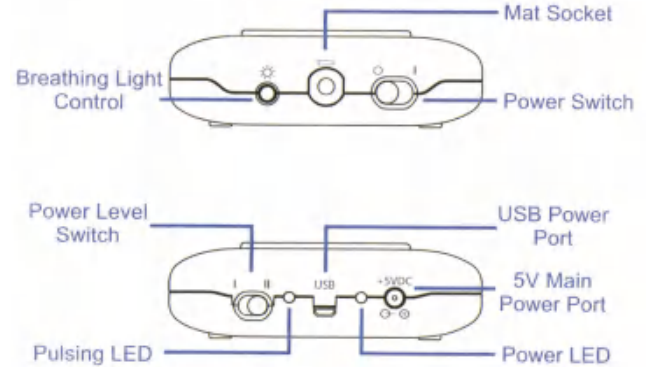

Preparing For Use

There are 4 simple steps to prepare Big Magic for use:

- Plug in the power supply.
- Connect and position the mat.
- Set the desired power level and turn on.
- Test.

Here are the steps in more details:

Plug in the power supply

There are two options to supply power to Big Magic.

- 1) Mains power, using the supplied 5v power adapter.
- 2) USB power source, such as a 5v portable power bank, 5v phone charger, or computer.



Power Adapter



USB Power Source
(5v Phone Charger)

You can choose the power option which best suits your needs.

Connect and position the mat

Plug the mat into Big Magic. Make sure the plug key matches the groove in the socket.



13

Place the PEMF mat under the area of your body where you wish to receive the PEMF treatments.



The mat is long enough to cover your entire spine. For a full night treatment, you can place it under the sheets of your bed. You may place a towel over the pad if you want greater comfort.

Set the desired power level and turn on



14



- Set the power level using the switch. Level two is the one we recommend. If you are sensitive, you can select level one.



- Turn on Big Magic using the switch located on the right.

Test

Place the Coil Tester on the PEMF mat. The red lights should flash rapidly during operation. The coil tester should be placed in the middle of the mat like this.

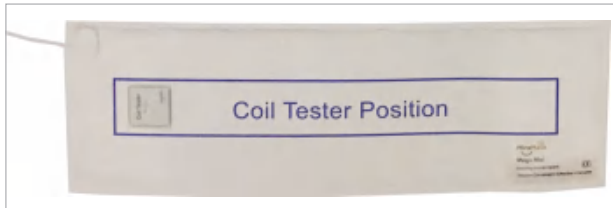

Indicator Lights

Big Magic has 3 lights:



1. Power LED
The right LED illuminates when Big Magic is receiving power.



2. Pulsing LED
The left LED flashes each time Big Magic sends an electrical pulse to the mat.



3. Breathing LED
The beautiful breathing light shows Big Magic is running.



- If you place the unit on a bedside cabinet, it may distract you from sleeping. Push this button to turn off the light.

Tips

1. The PEMF mat can be folded for ease of use and transport. Convenient for business trips or family vacations.
2. Clean the main unit and the mat using a damp cloth, and dry before using.
3. For extra convenience, Big Magic can run continuously, with very low power consumption.

Flash

MiraMate

Brief Overview

Flash is possibly the most useful healthcare product you can own. It is almost certainly the most convenient. Pathogens on the skin can be destroyed within seconds, just by pressing one button.

According to clinical trials, VUV light can benefit human, pets and plants. It can also be used to kill mold spots on walls.

For humans, VUV light can help with acne, psoriasis, age spots, human malignant melanoma, vitiligo, eczema, persistent itching (pruritus), fungal skin problems such as toe and nail fungus, bacteria or viruses, cutaneous T-cell lymphoma and other skin issues.

MiraMate Flash is extremely simple to use. Just plug in, place over the desired skin site, pull the trigger, and bugs are gone.

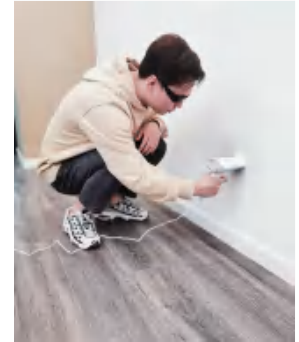

New to VUV

UV Light Classification

Ultraviolet (UV) is electromagnetic radiation with a wavelength between 40 nm and 400 nm. It falls in the range of the electromagnetic (EM) spectrum between visible light and X-rays. UV light can generally be subdivided into four parts: UVA, or near UV (315 - 400 nm), UVB, or middle UV (280 - 315 nm), UVC, or far UV (180 - 280 nm) and Vacuum UV (40 nm to 200 nm). Decreasing wavelengths correspond with higher frequencies and higher photon energy.

Definition of VUV

VUV is Vacuum Ultraviolet. It's called vacuum because this type of ultraviolet does not travel well through air. The photon energy of VUV is very high, and almost any substance absorbs it. Normal air reduces the strength, so the further it goes, the weaker it becomes.

Working Theory of VUV

Ultraviolet (UV) light can efficiently kill all bacteria, including drug-resistant bacteria and even so-called "superbugs" such as MRSA. Unfortunately, conventional germicidal UV light with wavelengths above 280 nm is considered biologically harmful for human skin. Unprotected exposure to 280 - 400 nm UV light can lead to skin cancer and premature aging. It can also cause eye damage such as cataracts and eyelid cancers.

Researchers at the Columbia University Medical Center found that UV light in the range from 180 - 280 nm does not penetrate through the outer, dead layer of skin. It does not harm the live skin cells below. However, it does penetrate and kill bacteria and viruses living on the skin.

Photons of VUV light cannot penetrate the epidermal layer. That's why VUV light will not cause any damage to human cells. However, UV photons set off a chemical reaction. Ozone and nitric oxide are created within your tissue, which clears bacterial, viral, fungal and parasitic infections.

Healthy cells thrive on oxygen and can't live without it. Disease-causing nasties like bacteria, fungi, parasites and microbes are anaerobic, and die in the presence of oxygen. Ozone is a powerful, activated form of oxygen. The ozone produced kills anaerobic organisms, without affecting healthy cells.

Parcel Contents



Flash

X 1



Goggles

X 1



Power Supply

X 1



Single Hole Punch

X 1



Sticker

X 30



User Manual

X 1

Main Structure

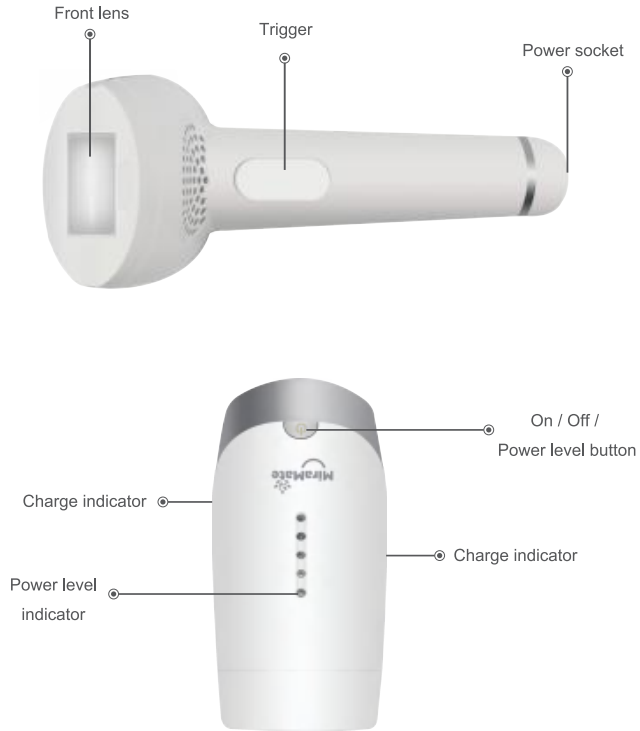

Power Adapter



Power adapter



Power socket

Operation Instructions

Basic Operation

Important Note:

Always wear protective glasses before using Flash.



Connect the power adapter into the power socket. The other end goes into the mains power source.



Long Press the "On/Off/Power level" button. Flash will turn on. You will hear the fan start to run. The charge indicator and power level indicator will shine a green light.



Press the "On/Off/Power level" button briefly to adjust the power level from low to high. Level 1 is the lowest power and level 5 is the highest. The default setting is level 1. The LEDs indicate the selected power level.



Level 1



Level 5

Touch the front lens on to the treated area, and pull the trigger. Flash will start producing bursts of VUV light.



After treatment, long press "On/Off/Power level" button to turn off Flash. Flash will automatically turn off after a period of inactivity.

Notes:

Flash will run continuously for up to one minute if the trigger is held on. Keep the trigger pressed for the desired number of flashes.

Everyone's skin is different. Some people have pale, sensitive skin. We recommend starting slowly, to find your optimum Flash settings.

For the first day of treatment, we recommend to flash only once at maximum power for each treatment position.

Increase the number of flashes the next day if your skin has not turned red and further treatment is required.

Flash Area

Flashing A Small Area

If you use Flash for a small area (smaller than the front lens area), you can use the provided UV protection stickers to shield the surrounding skin.



Use the supplied hole punch to cut a hole in the sticker. The hole size should match the desired treatment area. You can make the hole larger or change its shape by making multiple cuts.



Position the sticker on your skin, ensuring the skin blemish is exposed by the hole.

Position front lens of Flash onto the sticker, and commence normal treatment.



Flashing A Large Area

If you use Flash for a **large area** (larger than the front lens area), treat one section at a time.



Other Uses

Flash can be used to kill mold spots on walls and mold on plants. Position the front lens as close as possible to the mold and flash multiple times. Plants are damaged by heat, so start with one flash, and slowly increase the number of flashes if there is no foliage damage.



Cautions

- ⚠ Do not use if you are pregnant, trying to become pregnant (conceiving) or breast-feeding. Hormonal changes occur during pregnancy or breast-feeding which may increase the risk of skin injury or skin sensitivity.
- ⚠ Do not use if you have epilepsy or light-induced seizures or migraines.
- ⚠ Do not use if you have a disease related to photo-sensitivity, such as porphyria, polymorphic light eruption, solar urticaria, lupus, etc. These conditions make the skin more sensitive to light treatment and could make the treatment uncomfortable or cause skin swelling, blisters or infection.
- ⚠ Do not use in your mouth.

- ⚠ Do not use the device if you have a history of Keloid scar formation, a known sensitivity to light (photo-sensitivity) or are taking medication that makes the skin more sensitive to light, including non-steroidal anti-inflammatory agents, (e.g., aspirins, ibuprofen, acetaminophen), tetracyclines, phenothiazines, thiazide, diuretics, sulfonyleureas, sulfonamides, DTIC, fluorouracil, vinblastine, griseofulvin, alpha retin-a, accutane and/or topical retinoids.
- ⚠ Do not shield the air intake or ventilation holes during use. Wear the supplied glasses during use.
- ⚠ Do not look at the light directly or use Flash for your eyes.
- ⚠ Ensure your skin is clean and free of any sunblock or skincare products before use.
- ⚠ Use a dry or slightly damp soft cloth to clean the body of Flash. Do not use cleaning products which contain alcohol or other harsh solvents.

- ⚠ Keep Flash away from liquid, and store in a dry location.
- ⚠ Keep Flash far away from children.
- ⚠ Do not insert metal objects into Flash.
- ⚠ Don't share Flash if you have a contagious skin disease.
- ⚠ If the system becomes wet, immediately unplug and send back to the factory for repair. Do not try to disassemble and repair Flash yourself.

Transportation and Storage

General transportation is acceptable, but strong shocks, vibration, snow and rain exposure should be avoided in transportation. The packed device should be stored in a well-ventilated room with humidity levels no more than 80% RH and no corrosive gases.

Warranty

If found to be defective and used according to the instructions, Flash will be replaced or repaired for free within one year from the purchase date.

Service and repair is provided after the warranty period. Material and shipping costs will be charged as appropriate.

The warranty does not cover:

Damage caused by user negligence or product misuse. (For example, scratches, liquid damage or unauthorized replacement of parts).

Breakdown or damage caused by disassembling.

Breakdown or damage caused by accident.

Damage caused by natural disasters.

Specifications

Power: <36W

Input: AC 100V-240V 50/60Hz

Voltage: 24V 1.5A

Dimensions: 182*72*151mm

Colour: White

Joint Aid

MiraMate





Brief Overview

MiraMate Joint Aid is a cold laser therapy device specially designed for home use. Cold laser therapy delivers non-thermal photons of light to the body to help heal injured cells. MiraMate Joint Aid can stimulate cellular metabolism, improve blood circulation, diminish inflammation, relieve pain and accelerate tissue repair. Perfect for joints!

MiraMate Joint Aid is very easy to use. Set the power level and duration, then direct the light to target area and start. We recommend sessions of 30 minutes, once or twice per day. After 10 to 15 consecutive days, re-evaluate, and repeat if necessary.



Parcel Contents

	Host	X 1
	Power Adapter	X 1
	Portable Case	X 1
	Safety Goggles	X 1
	Manual	X 1

Main Structure

1. Main Unit

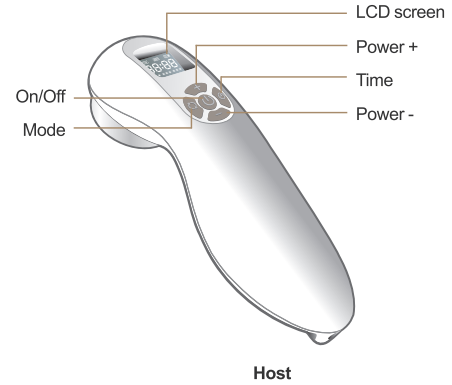

2. Laser Diodes

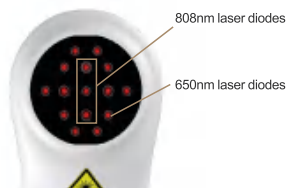

Three 808nm laser diodes
Twelve 650nm laser diodes

3. Power Adapter

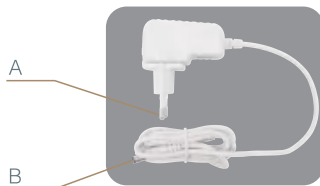

Power adapter



Power charger jack

Specifications

Laser medium	GaAlAs Semiconductor
Laser wavelength	650nm±20nm/808nm±20nm
Number of laser diodes	Three 808nm laser diodes Twelve 650nm laser diodes
Maximum output power per 808nm laser diode	150mW±20%
Maximum output power per 650nm laser diode	5mW±20%
Time setting	Selectable 15-60 minutes, in 5-minute increments
Battery voltage	DC 5V
Battery capacity	5200mAh
Input power	≤10VA
Environmental temperature	5 C-40 C
Relative humidity	80%
Atmospheric pressure	860mbar-1060mbar
Voltage	100-240V / 50-60 Hz

Only use the power adapter supplied.

Operation Instructions

1. Functions Setting and Keys Operations

1.1 Turn on

- 1) Long press "On/Off" (Figure 1).
- 2) In the process of turning on, buzzer will "beep".
- 3) All the icons on LCD screen will light up briefly when the device is turned on.

NOTE

The default factory setting is pulse mode, 30 minutes and mid-level power output (Figure 2). If no setting changes are necessary, directly press "On/Off" to start.



Figure 1



Figure 2

1.2 Mode Setting

1) After turning the device on, press "Mode" to select mode. There are two adjustable modes: "Pulse output mode" and "Continuous output mode".

Continuous wave lasers are best for pain control. Pulsed wave lasers are better for healing and reducing inflammation. We recommend using "Continuous output mode" for pain relief first and then "Pulse output mode" for long term healing.

2) Press "Mode". The buzzer will "beep", and the corresponding icon on the LCD screen will light up (Figure 3.)

NOTE

The default factory setting is pulse mode. If it is unnecessary to adjust the mode, please press "Time" directly to set the time.



Pulse output mode



Continuous output mode

Figure 3

1.3 Time Setting

- 1) Press "Time" to adjust the duration. Time increments are 5 minutes. The duration is adjustable from 15 to 60 minutes.
- 2) When "Time" is pressed, the buzzer will "beep", and the time icon on LCD screen will change.

NOTE

The default factory setting is 30 minutes. If it is unnecessary to adjust time, short press "Power" directly to set laser output power.

1.4 Laser Output Power: Intensity Setting

- 1) Press "+" or "-" to adjust the intensity of the laser output power. There are three levels of laser output intensity. Press "+" to increase power intensity, and press "-" to decrease power intensity.

Level 1 power is 170mW

Level 2 power is 340mW

Level 3 power is 510mW

- 2) When "+" or "-" is pressed, the buzzer will "beep", and the corresponding icon on the LCD screen will change (Figure 4).

NOTE

The default factory setting is mid-level power output. If it is unnecessary to alter the power intensity, please press "On/Off" directly to start.



1.5 Start and Pause

- 1) After setting working mode, time and laser output power intensity, short press "On/Off" to start the device. The buzzer will "beep", and the remaining time displayed.
- 2) When the treatment finishes, the buzzer will "beep". The LCD screen will return to the setting status, and laser lights will turn off.

1) After setting working mode, time and laser output power intensity, short press "On/Off" to start the device. The buzzer will "beep", and the remaining time displayed.

2) When the treatment finishes, the buzzer will "beep". The LCD screen will return to the setting status, and laser lights will turn off.

3) To pause the treatment, short press "On/Off". The buzzer will "beep", and time display will pause.

NOTE

Working mode, duration and laser power intensity cannot be adjusted during use. Before adjustment, pause the device (short press "On/Off").

1.6 Shutdown

Long press "On/Off" to turn off. The buzzer will give a confirmation "beep".

NOTE

The device has an automatic shutdown function to save energy. The device will automatically turn off after one minute of inactivity.

2. Recommendation

We recommend using this device once or twice a day for 30 minutes each time. The treatment cycle should be 10 to 15 days, with a rest-time between treatment cycles sessions of 5-7 days.

3. Charging Instructions

1) Charge when the icon of battery on the LCD screen starts flashing. This ensures the normal battery lifespan.

2) Insert power adaptor (A) into a household socket (100V-240V) and insert the plug (B) into the device for charging (Figure 5).

The buzzer will "beep" twice, and the battery icon on the LCD screen will show that the device is charging. When the device is fully charged, the battery icon will display normally.

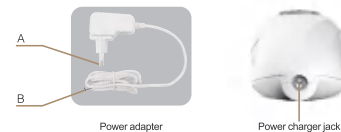

Figure 5

NOTE

1. The charging time should be over 10 hours for the first three charge cycles.
2. Do not use a non-standard power adaptor, as it may damage the device.

Trouble-shooting Instructions

Faults	Causes	Solutions
Device does not turn on.	<ol style="list-style-type: none">1. Insufficient time of pressing "On/Off".2. Battery is low.	<ol style="list-style-type: none">1. Long press "On/Off" over 3 seconds.2. Plug in the power adapter to charge. The device will turn on after being fully charged.
Laser light is off.	<ol style="list-style-type: none">1. "On/Off" is not short pressed.2. Battery is low.	<ol style="list-style-type: none">1. Short press "On/Off".2. The Lasers can light up normally after a full charge.
Weak or no laser light after turning on.	Damaged laser	Return the device for replacing or repairing.

Maintenance and Preservation

1) If the device breaks down, please use the "Trouble-shooting Instructions" to eliminate the problems. If the problems perseveres, please contact us.

To avoid unnecessary loss - Don't disassemble or repair the device by yourself.

2) To clean the surface of the device, please use cotton soaked in neutral cleaning fluid. Don't use organic solvents, gas etc.

3) Use cotton soaked in alcohol to gently clean the light emitting ports or lasers. Don't use harsh chemicals or liquids to soak the device or hard objects to clean it.

4) Please keep the device away from humidity, high temperatures and direct exposure to sunlight.

5) To avoid scratches on its surface or damage to the lasers, do not keep the device together with hard objects.

6) Recharge the battery after it runs out completely, charging should not be less than 10 hours for the first three times.

7) If you do not use the device for a long time, charge it at least every 4 to 6 months. This improves the battery life. Allowing the battery to lose charge for extended periods of time may result in premature battery failure.

Transportation and Storage

General transportation is acceptable, but strong shocks, vibration, snow and rain exposure should be avoided in transportation. The packed device should be stored in a well-ventilated room with humidity levels no more than 80% relative humidity and no corrosive gases.

Warranty

1) The device can be replaced or repaired for free in the case of quality problems under normal use within one year since purchasing.

2) We also provide maintenance services even after the warranty period. Material and shipping costs will be charged as appropriate.

3) Warranty doesn't cover:

- Damage caused by improper operation or mistakes.
- Breakdown or damage caused by disassembling.
- Breakdown or damage caused by accidents or human activities.
(scratches, soaking or unauthorized replacement of parts).
- Damage caused by natural disasters.

Symbol Descriptions

According to regulation EN60825-1, 2014 standard, each 3B laser product must be accompanied by a radiation warning sign and a radiation declarative sign.



Radiation warning sign



Radiation declarative sign

Description of other signs



No littering



keep dry



keep away from sunlight



CE Mark



Fragile



Up

Now you are ready to start your treatments!

If you have further questions, you can get help from:

Live Chat: miramate.com

Email: support@miramate.com